

Viewmold company provides high precise mold base with full manufacturing as DME, HASCO or custom standard. If you need it, welcome to contact us by sales@viemold.com.

# D-M-E Euro-Series Mold Bases

**Completely interchangeable plates that support regional standards worldwide**



OVERHANG  
CLAMP PLATES



## Features

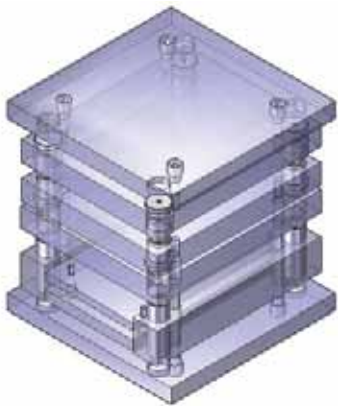

### Global solutions to regional standards

To meet the emerging need to support regional standards around the world, D-M-E introduces a new family of Euro standard mold bases, available worldwide. D-M-E Euro-Series mold bases offer many inherent benefits, but more importantly enable molders worldwide to employ Euro standard mold bases and components. And, since all D-M-E Euro-Series mold bases and components are in-stock, most are shipped the same day.

#### Precision fit

The common bore alignment design philosophy of the Euro-Series guarantees a perfect fit every time. Centering features ensure precise alignment of mating plates. All plates have clean chamfer, an extremely fine bore finish, and excellent surface finishes.

#### Modular

With its modular, flexible configuration and common bore alignment, Euro-Series plates are completely interchangeable. A single cavity plate can be used as either the A or B plate. The same clamp plate can be the Top Clamp Plate or Bottom Clamp Plate. The same Riser Plate can be used on either side of the housing.

#### Offset pin/bushing

The Euro-Series offset pin/bushing design means the offset hole is not out of position. Offset is achieved by the use of a differently-sized pin and bushing, combined with three uniformly sized pins.

#### Other key features

Euro-Series offers a wealth of other key features, including:

- Choice of flush or overhanging clamp plates
- Flexibility to use either a North American or European locating ring as there is no counterbore
- Wide range of European standard components available off-the-shelf
- Centering bushing aligns riser and offers easy threaded removal
- All plates clearly marked with steel type, plate code, and dimensions for easy identification

Viewmold company provides high precise mold base with full manufacturing as DME, HASCO or custom standard. If you need it, welcome to contact us by sales@viemold.com.

## Features



**Globally available regional standard**

**Precision fit**

**Interchangeable design**

**Common bore alignment**

**Flexible locating ring styles**

**Fine finishes**

**Offset guide pin/bushing**

**Wide range of Euro-Series components**

**Same day shipment**

**Choice of steel types**

Viewmold company provides high precise mold base with full manufacturing as DME, HASCO or custom standard. If you need it, welcome to contact us by sales@viewmold.com.

# Plate Dimensions

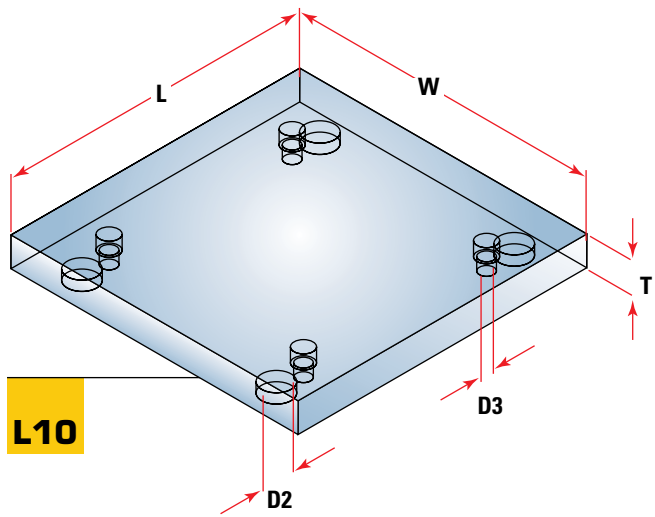

**L10**

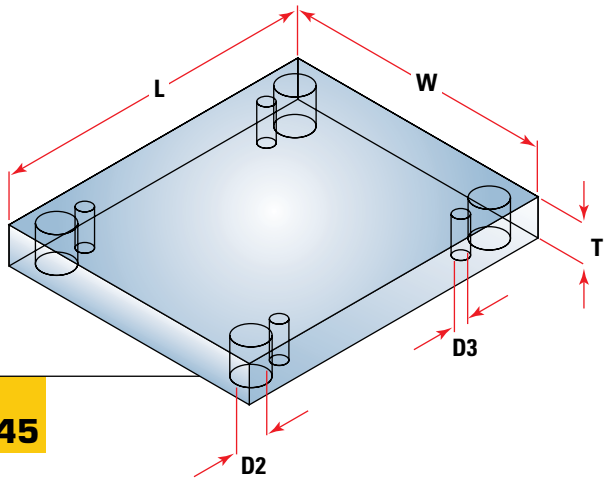

**L45**

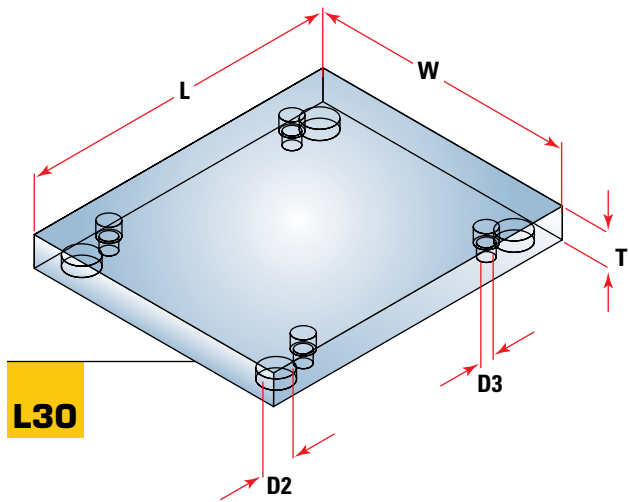

**L30**

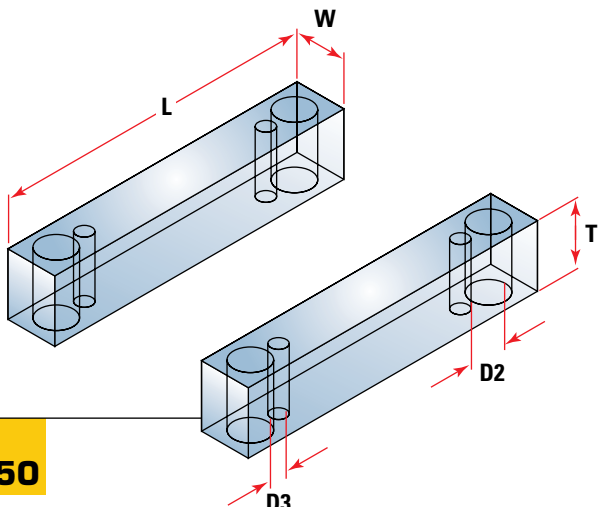

**L50**

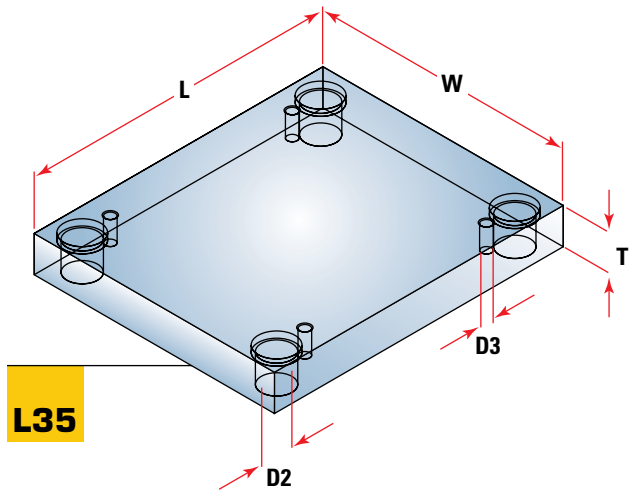

**L35**

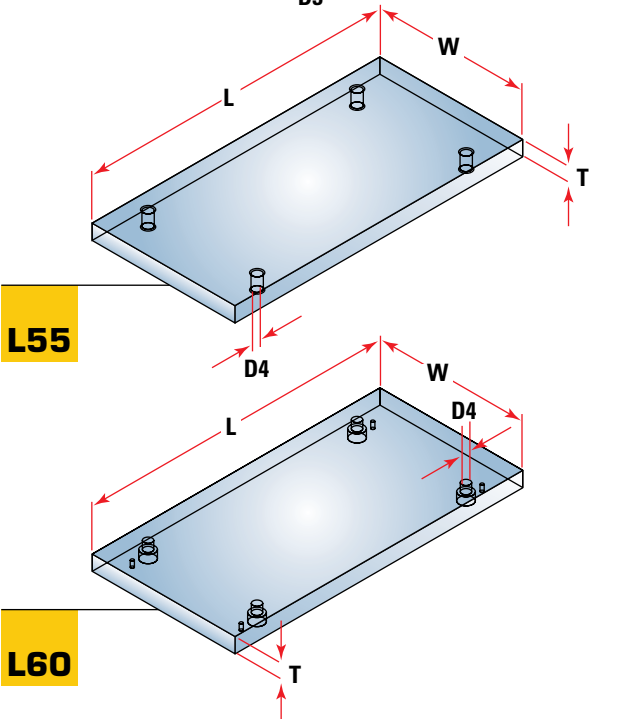

**L55**

**L60**

Viewmold company provides high precise mold base with full manufacturing as DME, HASCO or custom standard. If you need it, welcome to contact us by sales@viewmold.com.

## Plate Dimensions

Size code **2020 1925 2030 2525 2530 2535 2540 3030 3035 3040**  
 Nominal size **196 x 196 190 x 246 196 x 296 246 x 246 246 x 296 246 x 346 246 x 396 296 x 296 296 x 346 296 x 396**

		2020	1925	2030	2525	2530	2535	2540	3030	3035	3040
<b>W</b>	Width	196	190	196	246	246	246	246	296	296	296
	L10 width (with overhang)	246	254	246	296	296	296	296	346	346	346
<b>L</b>	Length	196	246	296	246	296	346	396	296	346	396
<b>X</b>	Length of bore centers	152	202	244	200	244	294	340	244	294	340
<b>Y</b>	Width of bore centers	154	148	150	200	200	194	198	250	244	248
<b>K</b>	Length of ER screw centers	132	182	230	180	230	286	330	230	286	330
<b>R</b>	Length of assy screw centers	100	150	186	130	186	224	284	186	224	284
<b>J</b>	Width of ER screw centers	96	90	90	130	130	136	122	180	186	176
<b>V</b>	Length of RP centers	166	216	266	214	264	324	364	266	324	364
<b>Z</b>	Width of RP centers	96	90	90	130	130	136	122	180	186	176
<b>P</b>	L50 riser width	38	38	43	43	43	43	47	43	43	47
<b>ER</b>	L55 ER thick	12	12	12	12	12	17	17	12	17	17
<b>EB</b>	L60 EB thick	17	17	17	17	17	22	22	17	22	22
<b>M</b>	L55, L60, ER, EB width	118	112	108	158	158	158	150	208	208	200
<b>D1</b>	Bush ID	26	26	30	30	30	30	30	30	30	30
<b>D2</b>	Bore ID	31	31	35	35	35	35	35	35	35	35
<b>D3</b>	Assy screws	M10	M10	M12	M12	M12	M12	M12	M12	M12	M12
<b>D4</b>	ER screws	M8	M8	M8	M8	M8	M8	M8	M8	M8	M8

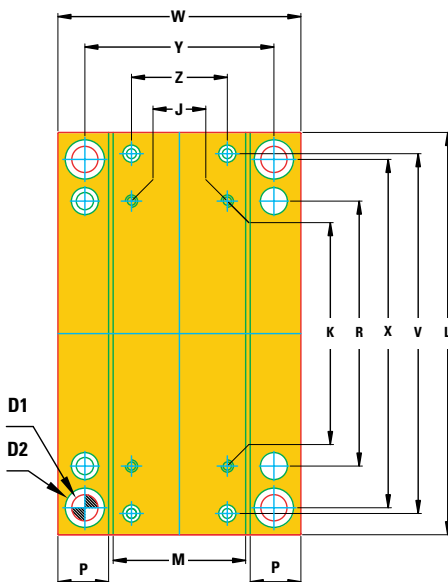
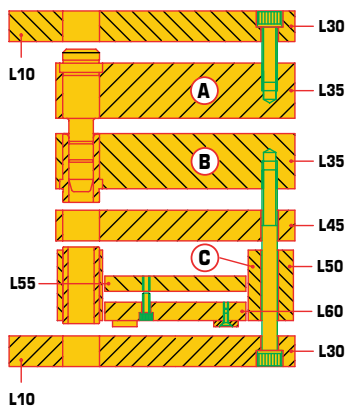

### Euro-Series Plate Tolerances

	mm	L10, L55, L60	L50	L30, L45	L35
<b>W, L</b>	up to 100	+/- 0.06	+/- 0.06	+/- 0.03	+/- 0.008
	> 100 - 180	+/- 0.08	+/- 0.08	+/- 0.04	+/- 0.010
	> 180 - 315	+/- 0.10	+/- 0.10	+/- 0.05	+/- 0.012
	> 315 - 500	+/- 0.12	+/- 0.12	+/- 0.05	+/- 0.014
	> 500 - 710	+/- 0.15	+/- 0.15	+/- 0.05	+/- 0.017
	> 710 - 1000	+/- 0.20	+/- 0.20	+/- 0.05	+/- 0.020
<b>T</b>		+0.2 / +0.3	0 / +0.02	+0.2 / +0.3	+0.2 / +0.3
<b>X, Y</b>	up to 100	+/- 0.008	+/- 0.008	+/- 0.008	+/- 0.008
	> 100 - 180	+/- 0.010	+/- 0.010	+/- 0.010	+/- 0.010
	> 180 - 315	+/- 0.012	+/- 0.012	+/- 0.012	+/- 0.012
	> 315 - 500	+/- 0.015	+/- 0.015	+/- 0.015	+/- 0.015
	> 500 - 710	+/- 0.018	+/- 0.018	+/- 0.018	+/- 0.018
	> 710 - 1000	+/- 0.020	+/- 0.020	+/- 0.020	+/- 0.020

## Ordering Information

D-M-E Euro-Series Mold Bases are ordered and delivered as individual items. Any item can be ordered at any time and assembled with a new or existing Euro-Series Mold Base. Ordering is as simple as selecting the items you need and calling D-M-E Customer Service.

### Steel Type Availability

DIN Type	1730	2738
D-M-E	#1	#3
L10, L30	✓	
L35	✓	✓
L45	✓	
L50, L55, L60	✓	

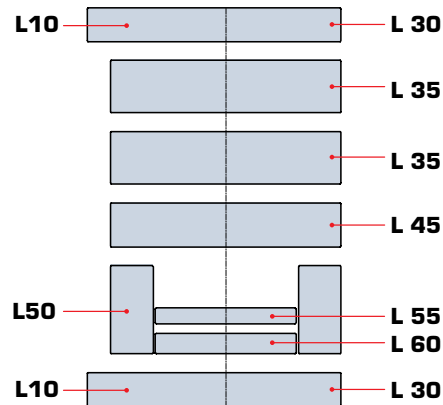

### Euro-Series Mold Base Product Line Item Number Code Logic

	L35	01	196	296	027
<b>Plate Code</b>	The letter L followed by two digits				
<b>Steel Code</b>	"01" for 1730 Steel (D-M-E #1) "17" for 2738 Steel (D-M-E #3)				
<b>Plate Width</b>	Three-digit number with a leading zero, if necessary				
<b>Plate Length</b>	Three-digit number with a leading zero, if necessary				
<b>Plate Thickness</b>	Three-digit number with a leading zero, if necessary				

### Examples

<b>L3501196296027</b>	L35 cavity plate from 1730 steel (#1) that is 196mm wide by 296mm long and 27mm thick
<b>L4501190246036</b>	L45 cavity plate from 1730 steel (#1) that is 190mm wide by 246mm long and 36mm thick
<b>L3517246296056</b>	L35 cavity plate from 2738 steel (#3) that is 246mm wide by 296mm long and 56mm thick



## Ordering Information

<b>2020</b> 196 x 196	<b>1925</b> 196 x 246	<b>2030</b> 196 x 296	<b>2525</b> 246 x 246	<b>2530</b> 246 x 296	<b>2535</b> 246 x 346	<b>2540</b> 246 x 396	<b>3030</b> 296 x 296	<b>3035</b> 296 x 346	<b>3040</b> 296 x 396
--------------------------	--------------------------	--------------------------	--------------------------	--------------------------	--------------------------	--------------------------	--------------------------	--------------------------	--------------------------

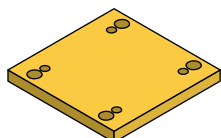
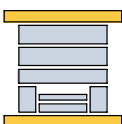
**L10**

	<b>2020</b>	<b>1925</b>	<b>2030</b>	<b>2525</b>	<b>2530</b>	<b>2535</b>	<b>2540</b>	<b>3030</b>	<b>3035</b>	<b>3040</b>
<b>1730 Steel (#1)</b>	27	27	27	27	27	27	27	27	27	27

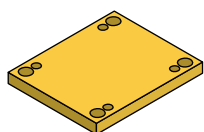
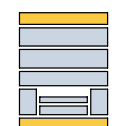
**L30**

<b>1730 Steel (#1)</b>	NA	NA	27	27	27	27	27	27	27	27
------------------------	----	----	----	----	----	----	----	----	----	----

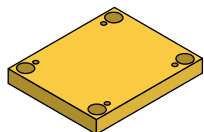
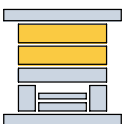
**L35**

<b>1730 Steel (#1)</b>	36	36	36	36	36	36	36	36	36	36
	46	46	46	46	46	46	46	46	46	46
	66	66	66	66	66	66	66	66	66	66
<b>2738 Steel (#3)</b>	36	36	36	36	36	36	36	36	36	36
	46	46	46	46	46	46	46	46	46	46
	66	66	66	66	66	66	66	66	66	66

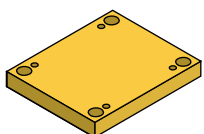
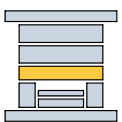
**L45**

<b>1730 Steel (#1)</b>	27	27	36	36	36	36	36	36	36	36
------------------------	----	----	----	----	----	----	----	----	----	----

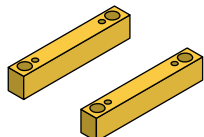
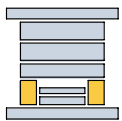
**L50**

<b>1730 Steel (#1)</b>	56	56	56	56	56	56	56	56	56	56
	76	76	76	76	76	76	76	76	76	76
	96	96	96	96	96	96	96	96	96	96

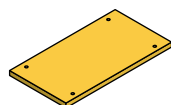
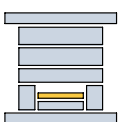
**L55**

<b>1730 Steel (#1)</b>	12	12	12	12	12	17	17	12	17	17
------------------------	----	----	----	----	----	----	----	----	----	----

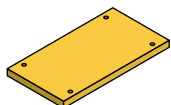
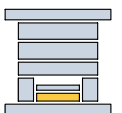
**L60**

<b>1730 Steel (#1)</b>	17	17	17	17	17	22	22	17	22	22
------------------------	----	----	----	----	----	----	----	----	----	----

Note: All dimensions provided are in millimeters and reflect plate thickness.

# Euro-Series Components

## Guide pins with collar

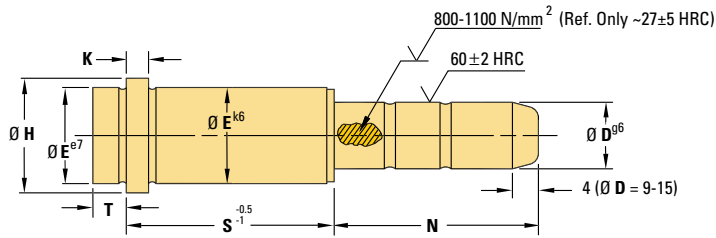

### Information Key

- D = Pin Body Diameter
- E = Shoulder Diameter
- H = Head Diameter
- K = Head Thickness
- N = Pin Body Length
- S = Shoulder Length
- T = Collar Length

ITEM PREFIX	D	E	H	K	T	S	N																									
							020	025	030	035	045	050	055	060	065	070	075	085	090	095	105	110	125	135	145	150	155	165				
GDP-EC (R02)*	09 or 10	14	16	3	3	012																										
						017																										
						022	⚡																									
						027		⚡																								
						036	⚡																									
						046																										
GDP-EC (R02)*	14 or 15	20	25	6	9	056																										
						017																										
						022																										
						027																										
						036																										
						046																										
						056																										
						066																										
						076																										
						086																										
						096																										
116																																

ITEM PREFIX	D	E	H	K	T	S	N																									
							035	045	055	065	075	085	095	105	115	120	125	130	135	145	155	165	205	225	245	255	285					
GDP-EC (R02)*	18 or 20	26	31	6	9	017																										
						022																										
						027	⚡	⚡																								
						036	⚡																									
						046	⚡	⚡																								
						056	⚡																									
						066																										
						076																										
						086																										
						096																										
						GDP-EC (R02)*	22 or 24	30	35	6	9	116																				
017																																
022																																
027	⚡	⚡																														
036	⚡																															
046	⚡	⚡																														
056	⚡																															
066																																
076																																
086																																
096																																
136																																
156																																

\* "(R02)" is only a cross-reference to current D-M-E Europe Catalog item prefix numbers.

**How to order:** Specify Item Number with prefix, D diameter, S length and N length. Include zeros and dashes but omit decimals, as shown.

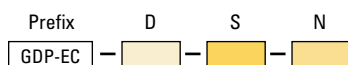

**Examples:**

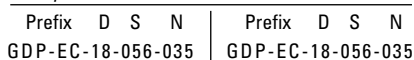

**Availability**

- ⚡ Items in stock
- Yellow square 2-3 week delivery
- White square Contact D-M-E for quote



# Euro-Series Components

## Guide pin bushing with collar

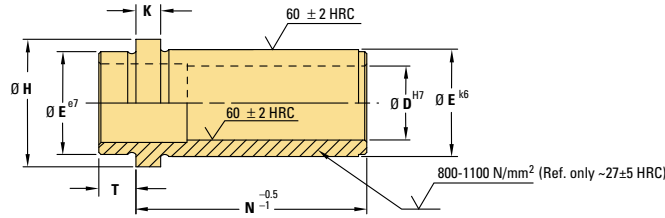

### Information Key

- D = Inner diameter
- G = Outer diameter
- H = Head diameter
- K = Head height
- N = Bushing Length from Head
- T = Collar Length

ITEM PREFIX	D	E	H	K	T	N														
						017	022	027	036	046	056	066	076	086	096	116	136	156	196	246
GDB-ECS (R04)*	14 or 15	20	25	6	9		⚡	⚡	⚡	⚡	⚡									
	18 or 20	26	31	6	9			⚡	⚡	⚡	⚡	⚡								
	22 or 24	30	35	6	9				⚡	⚡	⚡	⚡	⚡							
	30 or 32	42	47	6	9					⚡	⚡	⚡	⚡	⚡	⚡					
	40 or 42	54	60	10	12															

**How to order:** Specify Item Number with prefix, D diameter, and N length. Include zeros and dashes but omit decimals, as shown.

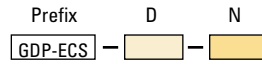

### Examples:

Prefix	D	N	Prefix	D	N
GDP-ECS	18	033	GDP-ECS	32	116

## Centering bushing

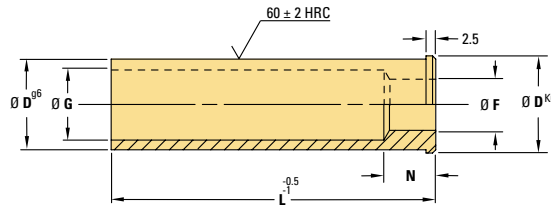

### Information Key

- D = Outside diameter
- F = Inside Diameter
- G = Inside Clearance Diameter
- L = Length
- N = Inside length

ITEM PREFIX	D	F	G	N	L															
					020	030	040	050	060	070	080	100	120	140	160	180	200	240	280	300
R05	14	6	11	8																
	20	8	16	13					⚡		⚡	⚡								
	26	10	21	13					⚡		⚡	⚡	⚡							
	30	12	25	13					⚡		⚡	⚡	⚡	⚡						
	42	16	33	13					⚡		⚡	⚡	⚡	⚡	⚡					
	54	20	43	13																

**How to order:** Specify Item Number with prefix, D diameter, and N length. Include zeros and dashes but omit decimals, as shown.

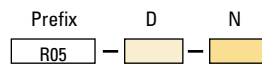

### Examples:

Prefix	D	N	Prefix	D	N
R05	20	040	R05	42	140

### Availability

- ⚡ Items in stock
- 🟡 2-3 week delivery
- Contact D-M-E for quote

# Euro-Series Components

## Socket head cap screws

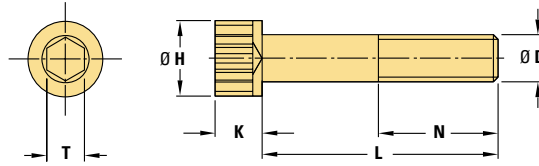

### Information Key

- D = Thread Diameter
- H = Head Diameter
- K = Head Height
- L = Length
- N = Thread Length
- T = Hex Socket Size (Across Flats)

D	N	H	K	T	L																							
					8	10	12	16	20	25	30	40	50	60	70	80	90	100	110	120	130	140	150	160	180	200	220	240
M4	12	7	4	3																								
M6	18	10	6	5																								
M8	22	13	8	6																								
M10	25	16	10	8																								
M12	28	18	12	10																								
M16	38	24	16	14																								
M16	44	24	16	14																								
M16	57	21	10	14																								
M20	52	30	20	17																								
M20	65	30	20	17																								

### How to order:

Specify Item Number with prefix, D diameter, and N length. Include zeros and dashes but omit decimals, as shown.

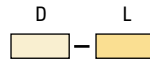

### Examples:

D	L	D	L
20	040	42	140

## R54 spring washers

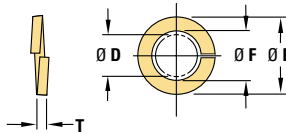

### Information Key

- D = Screw Diameter
- F = Inside Diameter
- P = Outside Diameter
- T = Thickness

ITEM NUMBER	D	F	P	T	AVAILABILITY
R54 08 2	08	8.1	12.7	2.0	
R54 10 2,5	10	10.2	16	2.5	
R54 12 2,5	12	12.5	18	2.5	

### How to order:

Specify Item Number. Include zeros and commas but omit decimals and all spaces (spaces are only shown here for easier reading).

## Flat head screws

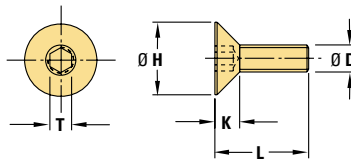

### Information Key

- D = Thread Diameter
- H = Head Diameter
- K = Head Height
- L = Length
- T = Hex Socket Size (Across Flats)

ITEM PREFIX	H	K	T	D	L																
					8	10	12	16	20	25	30	35	40	45	50						
SM3	6	2.5	1.7	M3																	
SM4	8	3	2.3	M4																	
SM5	10	4	2.8	M5																	
SM6	12	5	3.3	M6																	
SM8	16	6	4.4	M8																	
SM10	20	8	5.5	M10																	
SM12	24	10	6.5	M12																	

### How to order:

Specify Item Number with prefix and L length. Include zeros and dashes but omit all spaces.

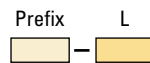

### Examples:

Prefix	L	Prefix	L
20	040	42	140

## R18 Disks

ITEM NUMBER	AVAILABILITY
R18 18	

Use with SM4 8 Flat Head Screw (M4 thread x 8mm long) which must be purchased separately. See Flat Head Screws above.

Drilled & countersunk for M4 thread flat head screw

### Availability

- Items in stock
- 2-3 week delivery
- Contact D-M-E for quote

## A Full Range of Euro-Series Components

As a global supplier of mold technology solutions, D-M-E is committed to supporting regional standards worldwide. That's why we offer over 4,000 different Euro-Series components to meet the European standards for mold systems. Key offerings include:

- Ejector pins, sleeves, and blades
- Guide pins and bushings
- Centering bushings and dowels
- Set screws, bolts, and washers
- Locating rings
- Sprue bushings
- See the D-M-E Mold Components catalog for our complete selection



# Metric Equivalents and Conversions

## Equivalents: Inch, fraction, decimal, millimeter

INCHES	MILLIMETERS	INCHES	MILLIMETERS
1	25.4	34	863.6
2	50.8	35	889.0
3	76.2	36	914.4
4	101.6	37	939.8
5	127.0	38	965.2
6	152.4	39	990.6
7	177.8	40	1016.0
8	203.2	41	1041.4
9	228.6	42	1066.8
10	254.0	43	1092.2
11	279.4	44	1117.6
12	304.8	45	1143.0
13	330.2	46	1168.4
14	355.6	47	1193.8
15	381.0	48	1219.2
16	406.4	49	1244.6
17	431.8	50	1270.0
18	457.2	51	1295.4
19	482.6	52	1320.8
20	508.0	53	1346.2
21	533.4	54	1371.6
22	558.8	55	1397.0
23	584.2	56	1422.4
24	609.6	57	1447.8
25	635.0	58	1473.2
26	660.4	59	1498.6
27	685.8	60	1524.0
28	711.2	61	1549.4
29	736.6	62	1574.8
30	762.0	63	1600.2
31	787.4	64	1625.6
32	812.8	65	1651.0
33	838.2	66	1676.4

INCHES		MILLIMETERS	INCHES		MILLIMETERS
1/64	0.015625	0.396875	33/64	0.515625	13.096875
1/32	0.031250	0.793750	17/32	0.531250	13.493750
3/64	0.046875	1.190625	35/64	0.546875	13.890625
1/16	0.062500	1.587500	9/16	0.562500	14.287500
5/64	0.078125	1.984375	37/64	0.578125	14.684375
3/32	0.093750	2.381250	19/32	0.593750	15.081250
7/64	0.109375	2.778125	39/64	0.609375	15.478125
1/8	0.125000	3.175000	5/8	0.625000	15.875000
9/64	0.140625	3.571875	41/64	0.640625	16.271875
5/32	0.156250	3.968750	21/32	0.656250	16.668750
11/64	0.171875	4.365625	43/64	0.671875	17.065625
3/16	0.187500	4.762500	11/16	0.687500	17.462500
13/64	0.203125	5.159375	45/64	0.703125	17.859375
7/32	0.218750	5.556250	23/32	0.718750	18.256250
15/64	0.234375	5.953125	47/64	0.734375	18.653125
1/4	0.250000	6.350000	3/4	0.750000	19.050000
17/64	0.265625	6.746875	49/64	0.765625	19.446875
9/32	0.281250	7.143750	25/32	0.781250	19.843750
19/64	0.296875	7.540625	51/64	0.796875	20.240625
5/16	0.312500	7.937500	13/16	0.812500	20.637500
21/64	0.328125	8.334375	53/64	0.828125	21.034375
11/32	0.343750	8.731250	27/32	0.843750	21.431250
23/64	0.359375	9.128125	55/64	0.859375	21.828125
3/8	0.375000	9.525000	7/8	0.875000	22.225000
25/64	0.390625	9.921875	57/64	0.890625	22.621875
13/32	0.406250	10.318750	29/32	0.906250	23.018750
27/64	0.421875	10.715625	59/64	0.921875	23.415625
7/16	0.437500	11.112500	15/16	0.937500	23.812500
29/64	0.453125	11.509375	61/64	0.953125	24.209375
15/32	0.468750	11.906250	31/32	0.968750	24.606250
31/64	0.484375	12.303125	63/64	0.984375	25.003125
1/2	0.500000	12.700000	1	1.000000	25.400000

## Equivalents: Decimal, millimeter

INCHES	MILLIMETERS	INCHES	MILLIMETERS	INCHES	MILLIMETERS
0.001	0.0254	0.01	0.254	0.1	2.54
0.002	0.0508	0.02	0.508	0.2	5.08
0.003	0.0762	0.03	0.762	0.3	7.62
0.004	0.1016	0.04	1.016	0.4	10.16
0.005	0.1270	0.05	1.270	0.5	12.70
0.006	0.1524	0.06	1.524	0.6	15.24
0.007	0.1778	0.07	1.778	0.7	17.78
0.008	0.2032	0.08	2.032	0.8	20.32
0.009	0.2286	0.09	2.286	0.9	22.86

## Measurement conversions

MULTIPLY BY	FROM → TO		MULTIPLY BY
	← TO	← FROM	
0.03937	inch	millimeter	25.4
0.0016	inch <sup>2</sup>	millimeter <sup>2</sup>	645.16
0.061	inch <sup>3</sup>	centimeter <sup>3</sup>	16.3871
0.2642	gallon (U.S.)	liter	3.7854
0.03527	oz. (avdp.)	gram	28.3495
2.2044	pound	kilogram	0.4536
62.43	lbs/ft <sup>3</sup>	g/cm <sup>3</sup>	0.0160
0.145	psi	kPa	6.8948
14.2247	psi	kg/cm <sup>2</sup>	0.0703
1.8°C + 32	°F	°C	(°F-32)/1.8